

FAG

**6022-2RSR**

Deep groove ball bearing

Schaeffler ID:  
0190948170000Deep groove ball bearing 60...-2RSR,  
single row, seals, steel sheet metal cage

## Technical information

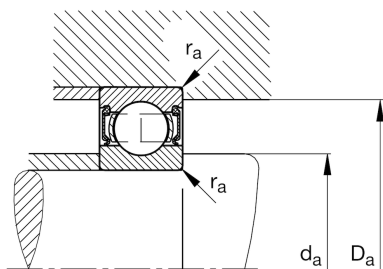
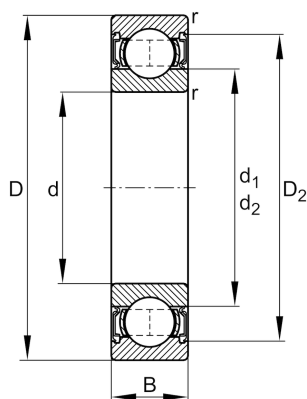
**Main Dimensions & Performance Data**

d	110 mm	Bore diameter
D	170 mm	Outside diameter
B	28 mm	Width
$C_r$	85.000 N	Basic dynamic load rating, radial
$C_{0r}$	71.000 N	Basic static load rating, radial
$C_{ur}$	3.550 N	Fatigue load limit, radial
$n_G$	2.080 1/min	Limiting speed
	2,06 kg	Weight

**Dimensions**

$r_{min}$	2 mm	Minimum chamfer dimension
$D_2$	155 mm	Caliber diameter outer ring
$d_1$	128,7 mm	Shoulder diameter inner ring

**Mounting dimensions**

$d_{amin}$	118,8 mm	Minimum diameter shaft shoulder
$D_{amax}$	161,2 mm	Maximum diameter of housing shoulder
$r_{amax}$	2 mm	Maximum fillet radius

**Calculation factors**

$f_0$	15,7	Calculation factor
-------	------	--------------------

**Temperature range**

$T_{min}$	-20 °C	Operating temperature min.
$T_{max}$	100 °C	Operating temperature max.